

**A3126 Leat Street, Tiverton, Proposed Zebra Pedestrian Crossing
Scheme for Formal Approval**

Report of the Head of Highways, Capital Development and Waste

Please note that the following recommendation is subject to consideration and determination by the Committee before taking effect.

Recommendation: It is recommended that the Zebra pedestrian crossing as shown on drawing No. C13008/03 be approved at an estimated cost of £45,000.

1. Summary

This report details proposals to introduce a Zebra controlled pedestrian crossing on Leat Street, Tiverton.

2. Background/Introduction

The primary walking route linking the western area of Tiverton to the hospital, Tiverton High School and Petroc Community College is along Kennedy Way from the roundabout on Leat Street.

This route entails crossing the A3126 adjacent to the roundabout which is difficult due to limited visibility of traffic exiting the roundabout onto Leat Street.

The provision of a zebra crossing will improve safety for vulnerable road users and promote safer walking routes to schools.

3. Proposal

The scheme proposal detailed on Drawing No. C13008/03 is for a Zebra controlled pedestrian crossing located on Leat Street south of the roundabout junction with Kennedy Way.

4. Consultations/Representations/Technical Data

Safety concerns have been raised by the schools and local residents. A petition of some 345 signatures requesting the provision of a crossing was presented to Mid Devon Highways and Traffic Orders Committee on 22 October 2012.

5. Financial Considerations

The total estimated cost of this scheme is £45,000. Funding for the scheme is identified within the 2013/2014 Market and Coastal Towns Foundation Programme of the Devon Local Transport Plan.

6. Sustainability Considerations

The scheme will support school travel plans and encourage walking, contributing towards a positive carbon impact by reducing car journeys.

7. Carbon Impact Considerations

The scheme will support school travel plans and encourage walking, contributing towards a positive carbon impact by reducing car journeys.

8. Equality Considerations

An Equality Impact and Needs Assessment (EINA) was undertaken for the Local Transport Plan. No negative impacts were identified.

9. Legal Considerations

The proposal will be advertised in accordance with the Road Traffic Regulation Act 1984.

10. Risk Management Considerations

Financial risk has been identified and appropriate allowances within the scheme estimate have been made to protect the Council's position.

11. Public Health Impact

The scheme promotes walking and provides enhanced access to the local hospital.

12. Options/Alternatives

Alternative crossing designs and locations were considered. Due to differences in ground levels and the visibility restrictions imposed by the roundabout, the choice of a zebra crossing provided the closest and most convenient crossing point of Leat Street.

13. Reason for Recommendation/Conclusion

Provision of a Zebra crossing at this location will enhance school and pedestrian links within the town and improve road safety for vulnerable users.

David Whitton
Head of Highways, Capital Development and Waste

Electoral Division: Tiverton West

Local Government Act 1972: List of Background Papers

Contact for enquiries: Rhys Davies

Room No. Barnstaple Civic Centre

Tel No: 07967040366

Background Paper	Date	File Reference
------------------	------	----------------

Nil

rd081013mdh
sc/cr/leat street tiverton zebra crossing
02 hq 091013

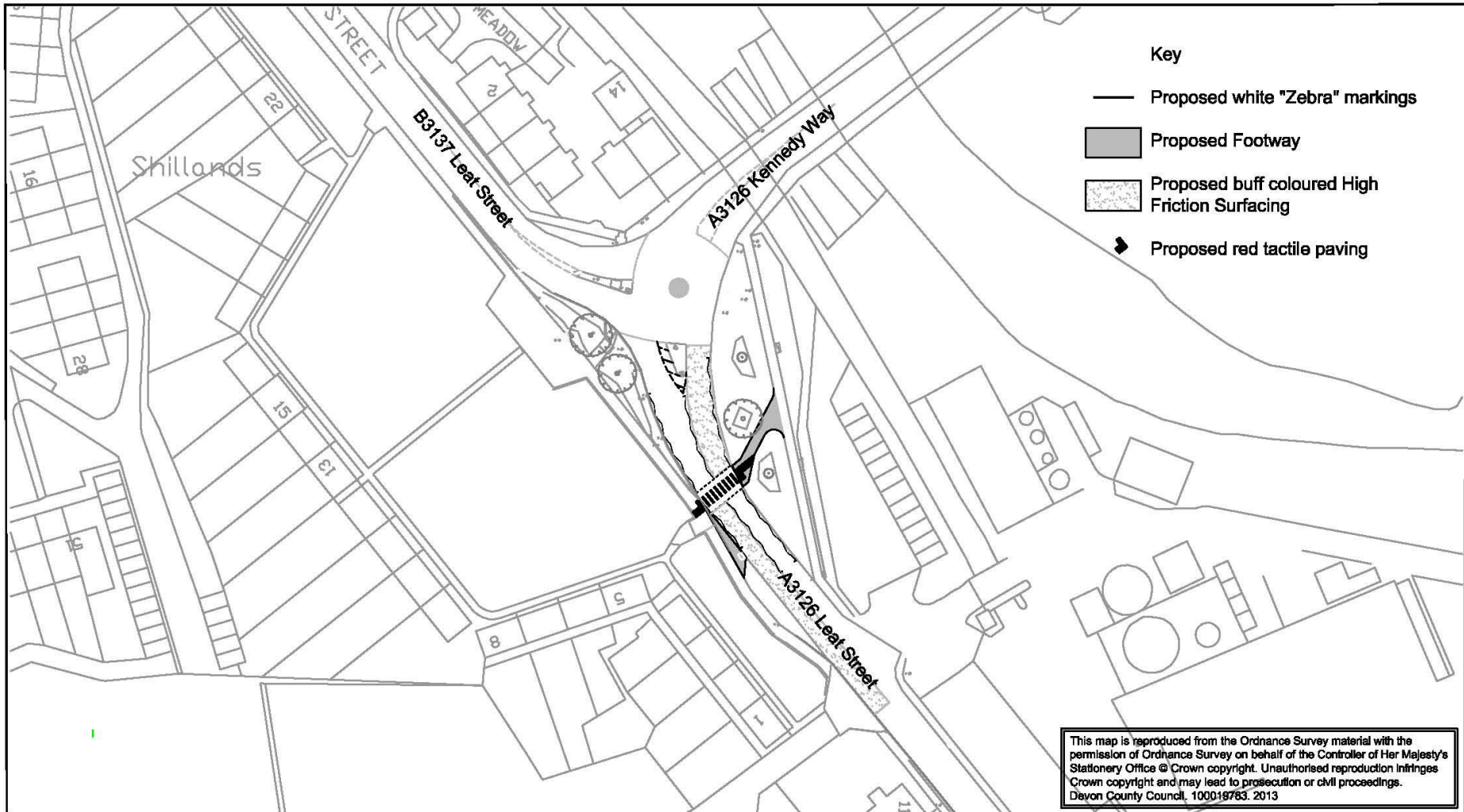

This map is reproduced from the Ordnance Survey material with the permission of Ordnance Survey on behalf of the Controller of Her Majesty's Stationery Office © Crown copyright. Unauthorised reproduction infringes Crown copyright and may lead to prosecution or civil proceedings. Devon County Council, 100019783, 2013

	Head of Highways Capital Development and Waste	Mid Devon HATOC	date SEPT 2013	scale 1:1000
		job/title/proposal A3126 LEAT STREET TIVERTON ZEBRA CROSSING	number C13008/03	